

Scope of plans Property layout

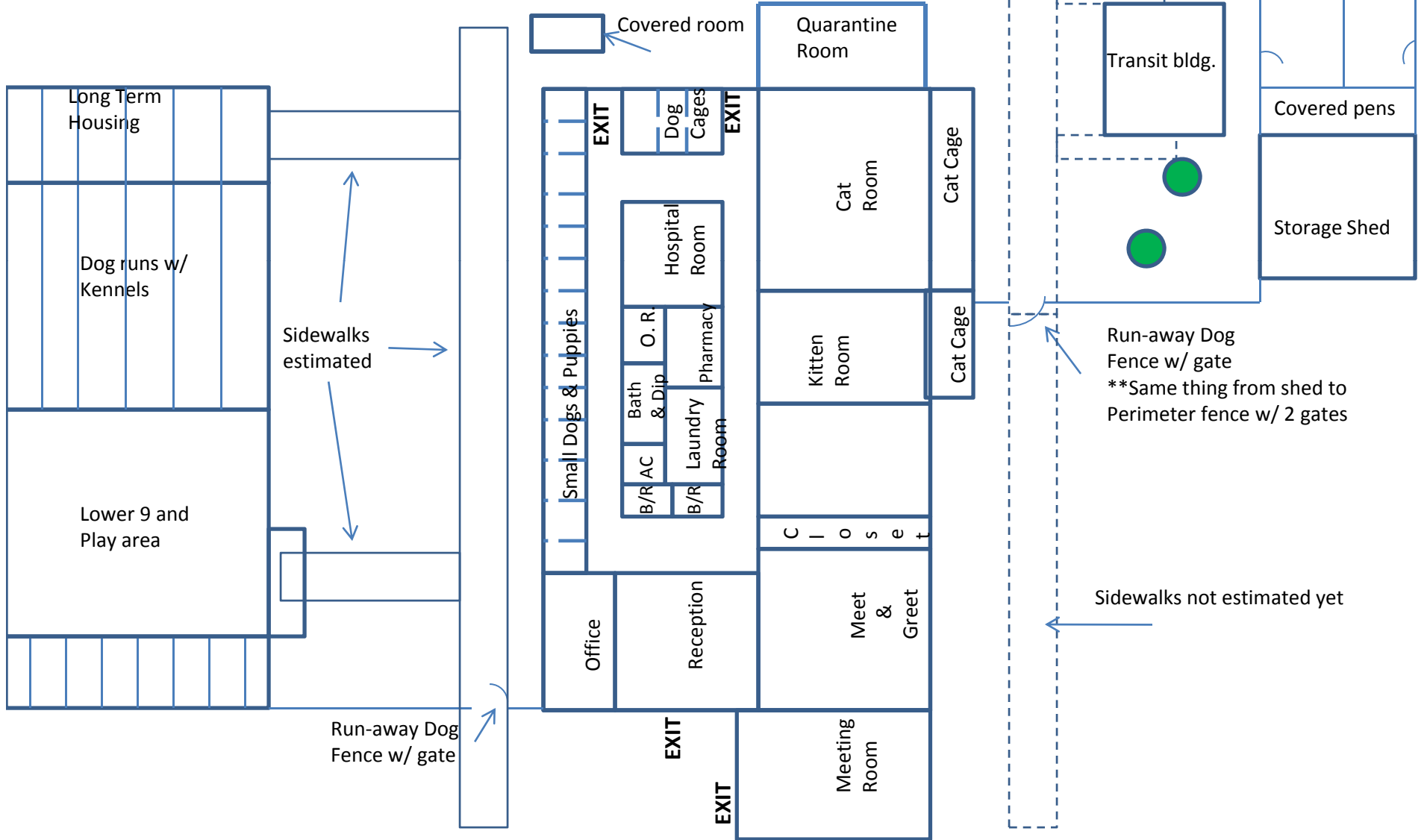

30' x 120' x 8' Dog Housing Building

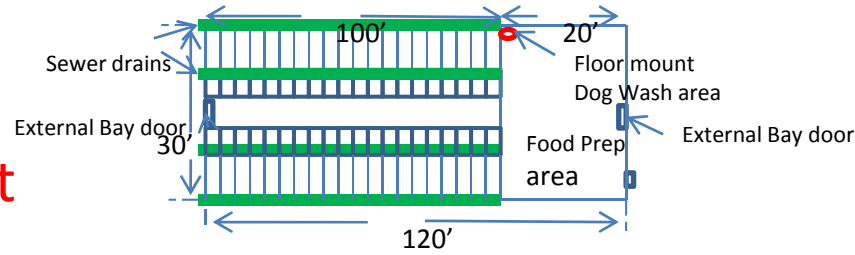
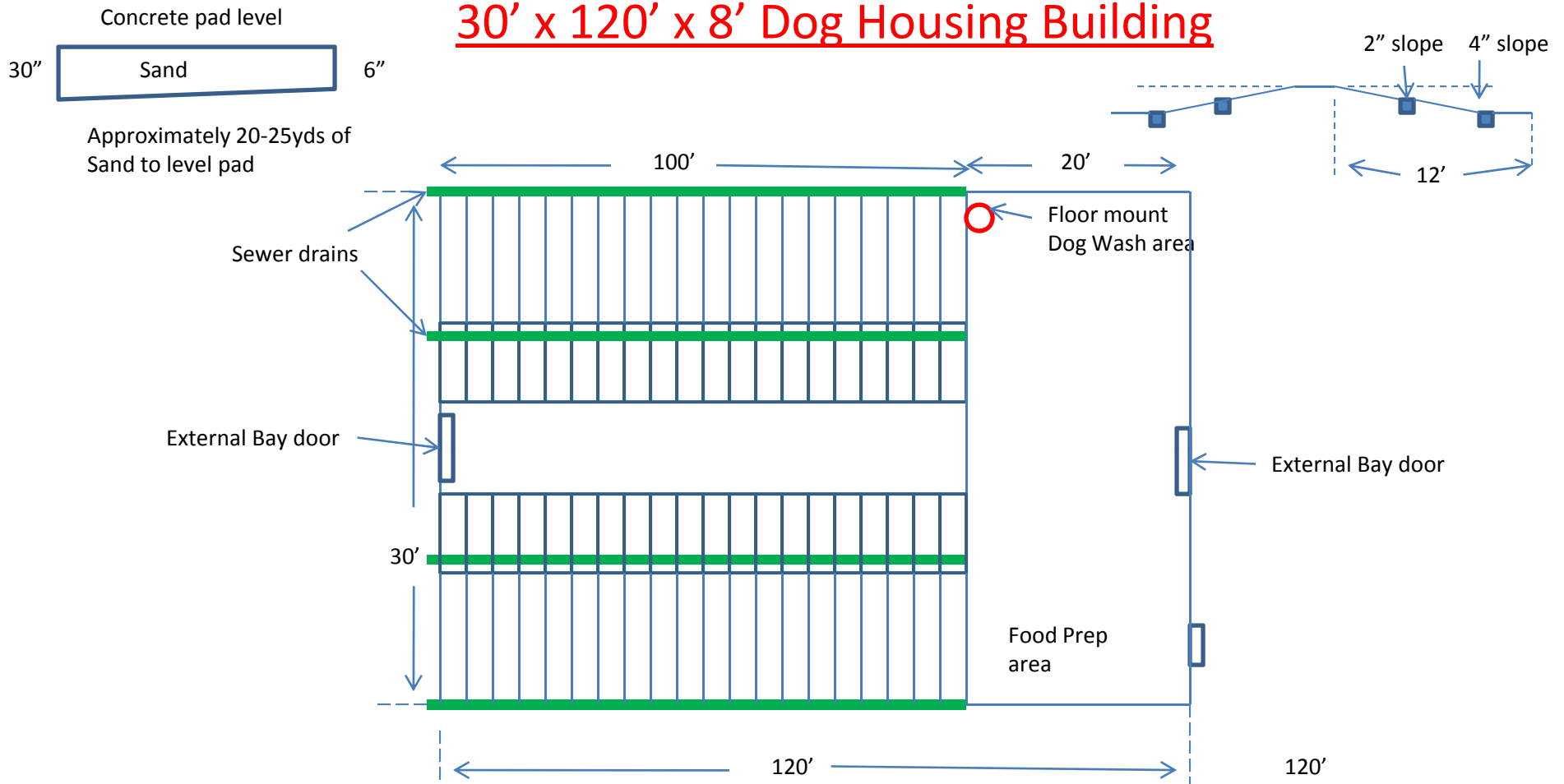

** Bldg holds approx. 40 dogs
 Cage size 5'x 12' each
 4 Sunlights per side on roof (?)
 Sidewalk around bldg. = 5' x 320', 20-23yds @ \$70yd is \$1,400-\$1,610
 Approximately 6"- 2-1/2' of sand to level pad above flood stage

** Waiting on contractors plans and Labor estimate.

82-85yds Concrete @ \$65.00yd = \$5,330-\$5,525
 Approx. 267pcs 3/8" rebar @ \$2.19 = \$584.73
 66pcs 1/2" rebar @ \$3.95 = \$260.70
 Sub total = \$6,370.43 w/o sand & plumbing

16' x 30' x 8' Quarantine Building

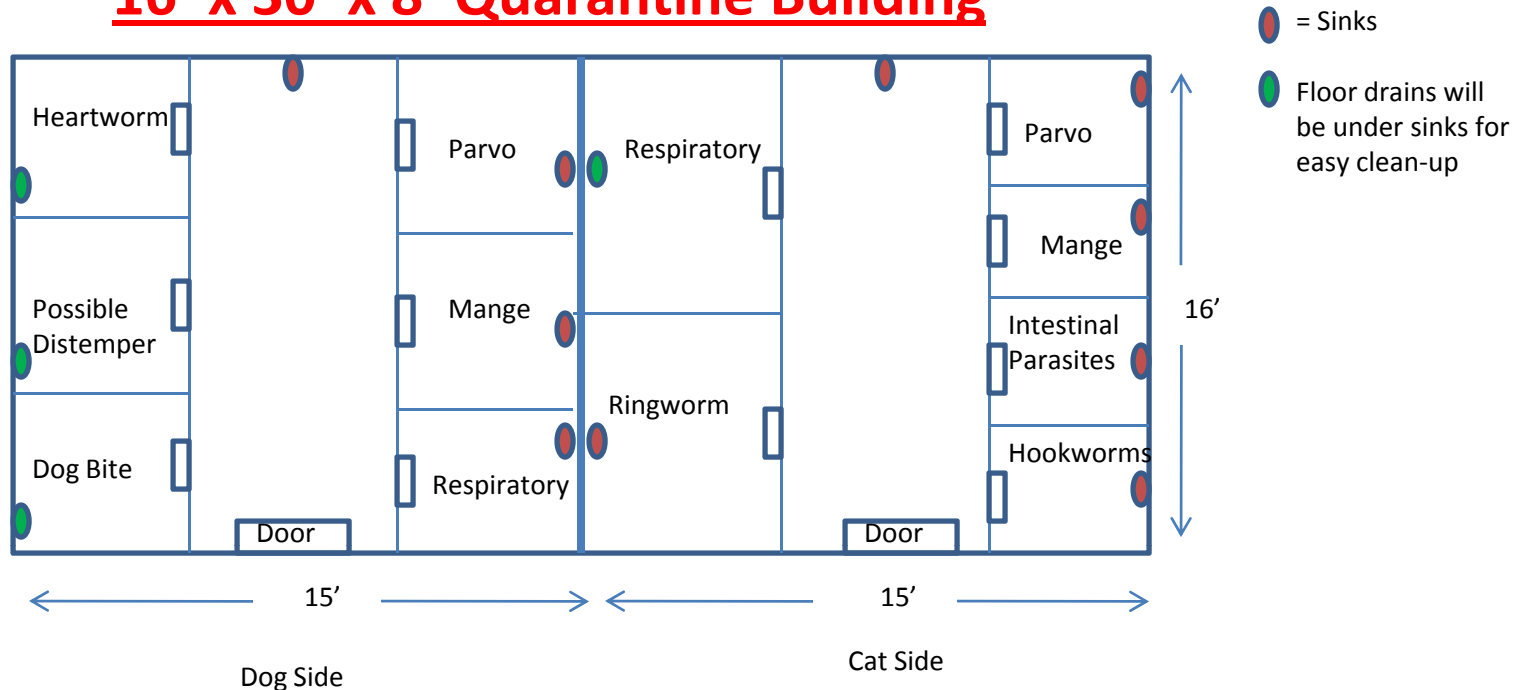

***Doors facing open field (West)

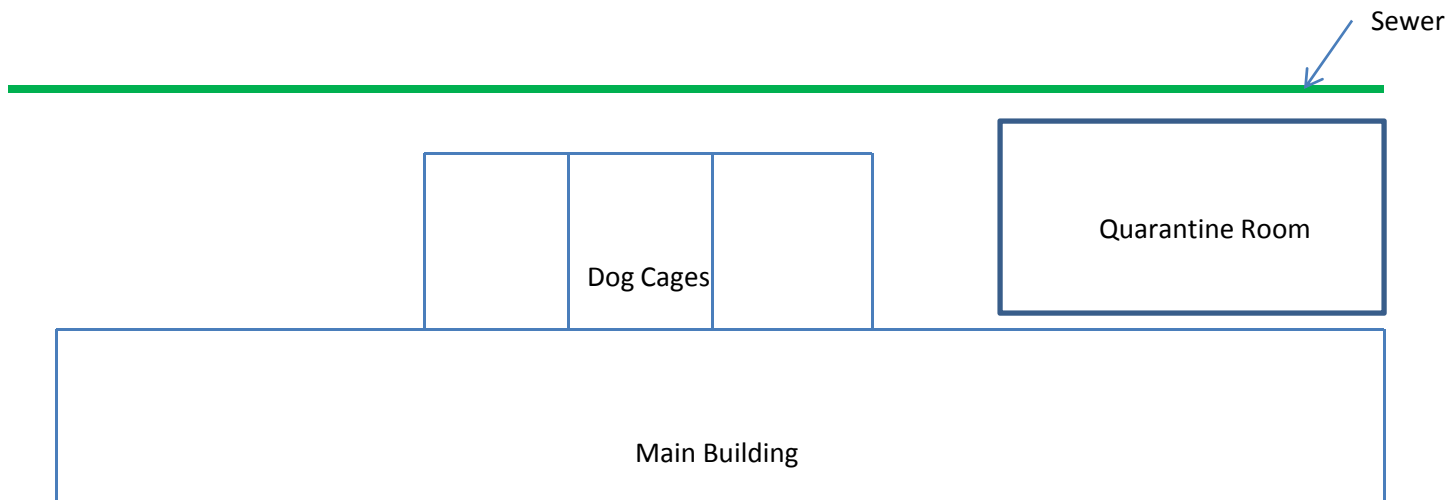

Materials

2x4's x10' = 80ea @ \$3.00ea = \$240.00

2x4's x 16' Treated = 12ea @ \$5.00ea = \$60.00

Doors 32" = 12ea @ \$100.00ea = \$1,200.00

Insulation = R-13, 3.5" @ \$8.48 roll, R-19, 6.5" @ \$ 27.84 bdl

4'x8'x1/2" Sheetrock = 50ea @ \$5.00ea = \$250.00

Compound = 20gals @ \$13.00 5gals = \$52.00

Tape = 5 rolls @ \$3.00ea = \$15.00

1-1/4" Screws = 2ea 5lb box @ \$24.00ea = \$48.00

Subtotal = \$1,865.00, **This does not include lighting, electrical,
AC & Heat, and insulation

****** Waiting on contractors plans and Labor estimate.

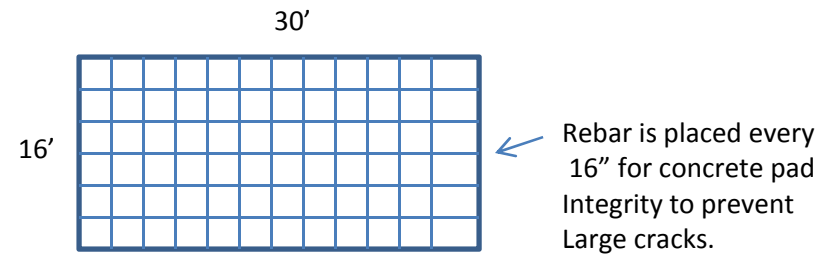

Concrete = 15-17yds @ \$65.00 per yd. = \$975-\$1,105

3/8" Rebar x 20' = 41pcs @ \$2.19ea = \$89.79

1/2" Rebar x 20' = 20pcs @ \$3.95ea = \$79.00

Sub total = \$1,273.79 w/o plumbing

20' x 20' x 8' Transit Building

- 1) Each cage approx. 6' x 7'
- 2) Floor sloped to center of bldg. to drain
- 3) 2 Sun-lights per side on roof (?)
- 4) Sidewalks only to doors (?)
- 5) Chain link cages w/ aluminum plates between cages

** Waiting on contractors plans and Labor estimate.

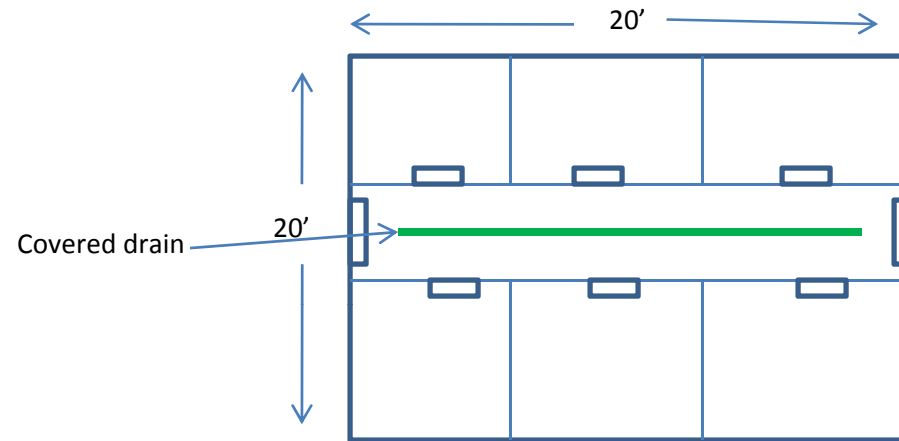
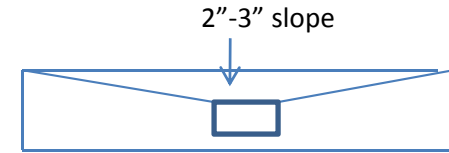

11-14yds @ \$65.00 = \$715.00-\$910
3/8" rebar, 30pcs @ \$2.19ea = \$65.70
1/2" rebar, 16pcs @ \$3.95ea = \$63.20
Sub total = \$1,038.90 w/o sand & plumbing

Concrete Projects

New Long Term Housing

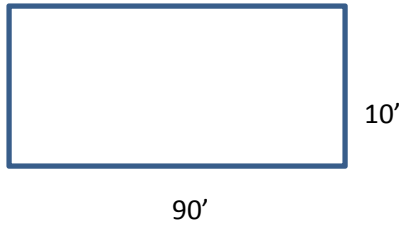

12-15yds Concrete @ \$70.00yd = \$840-\$1,050

90'



Lower 9 Pens

10'

12-15 yds Concrete @ \$70.00yd = \$840-\$1,050

58'



Lower 9 sidewalk

5'

4-5 yds Concrete @ \$70.00yd = \$280-\$350

100'



Long Term sidewalk

5'

7-8 yds Concrete @ \$70.00yd = \$490-\$560

110'



South side bldg. sidewalk

5'

7-8 yds Concrete @ \$70.00yd = \$490-\$560

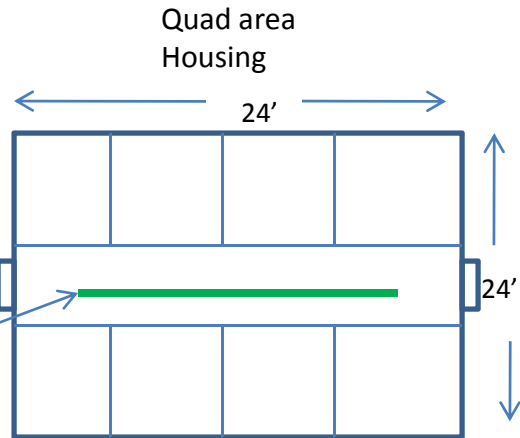

** Waiting on contractors plans and Labor estimate.

8-10 yds Concrete @ \$65.00yd = \$520-\$650

46pcs 3/8" rebar @ \$2.19ea = \$100.74

36pcs 1/2" rebar @ \$3.95ea = \$142.20

Sub total = \$892.94 w/o sand & plumbing supplies

** Checking w/ City if footing is needed for this pad

Patio

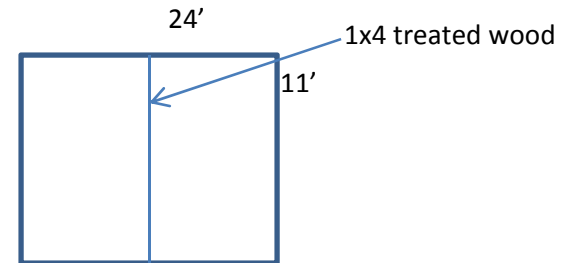

4 yds Concrete @ \$70.00yd = \$280

FENCE = South side 82' x 4' & 10' x 4'

Bldg-Shed 43' x 4' & 2' x 4'

Shed-Fence 177' x 4'

Gate Pads

- 1) ½" Rebar is placed on 2' centers
- 2) 145 pieces required for all gate pads @ \$3.95ea = \$572.75
- 3) Bundle or box of rebar ties
- 4) 30 yards concrete per gate, cost \$1,950.00

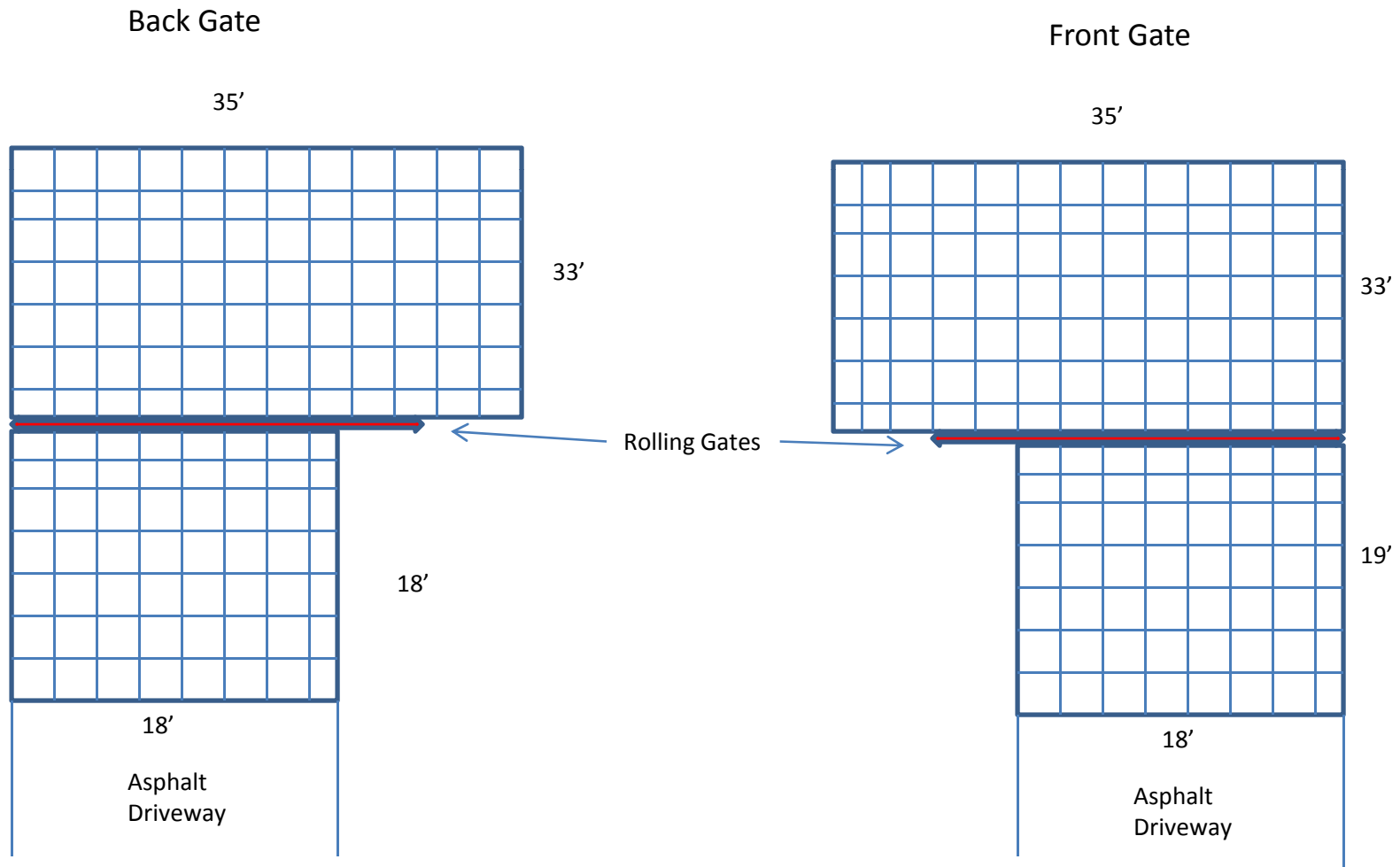

Shelter patio cover

